

AS SUPPLIED

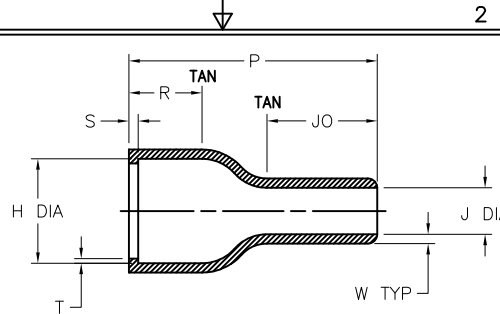

AFTER UNRESTRICTED RECOVERY

REVISIONS		
LTR	DESCRIPTION	DATE
A	INITIAL RELEASE OF DWG PER ECO-10-024786	12/03/2010

NOTES:

- ALL DIMENSIONS ARE IN: $\frac{\text{INCHES}}{[\text{MILLIMETERS}]}$
- DIMENSION APPEARING IN TABLE ARE AS FOLLOWS:
 a - AS SUPPLIED
 b - AFTER UNRESTRICTED RECOVERY

3 COATING (ADHESIVE) IS OPTIONAL. AS SUPPLIED DIMENSIONS APPEARING IN TABLE ARE FOR UNCOATED PARTS. WHEN COATING IS ADDED, ENTRY DIAMETER WILL BE REDUCED BY .06 MAX.

PART NUMBER	H		J		P	R	S	T	JO	W
	Min	Max	Min	Max	±10%	±10%	±10%	±20%	±10%	±20%
	a	b	a	b	b	b	b	b	b	b
202D142-XX-35	1.22 [31,0]	.70 [17,8]	1.22 [31,0]	.28 [7,2]	1.60 [40,6]	.59 [15,0]	.12 [3,1]	.04 [1,0]	.46 [11,7]	.08 [2,0]

ORDERING INFORMATION: 202D142 -XX -35 /XXX -0

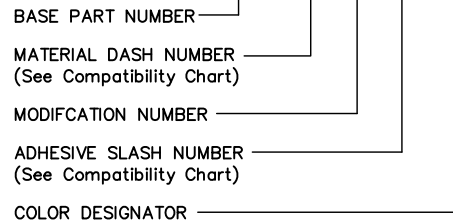

If this document is printed it becomes uncontrolled. Check for the latest revision

COMPATIBILITY CHART

MATERIAL DASH No.	MATERIAL DESCRIPTION	MATERIAL SPEC	ADHESIVE COATING SLASH No.	ADHESIVE COATING "S" No.
-3	POLYOLEFIN, SEMI-RIGID	RT-301	/42, /86	S-1017, S-1048
-4	POLYOLEFIN, FLEXIBLE	RT-1304	/42, /86, /87, /180	S-1017, S-1048, S-1052, S-1030
-25	ELASTOMER FLUID RESISTANT	RW-2070	/225	S-1206

UNLESS OTHERWISE SPECIFIED DIMENSIONS ARE INCHES. METRIC DIMENSIONS ARE IN BRACKETS.
 DECIMAL TOLERANCES
 .XXX ± 0.005 [0.13 mm]
 .XX ± 0.01 [0.25 mm]
 .X ± 0.1 [0.50 mm]
 ANGLE TOLERANCE
 .X ± 1 DEG.
 TYCO ELECTRONICS RESERVES THE RIGHT TO AMEND THIS DRAWING AT ANY TIME. USERS SHOULD EVALUATE THE SUITABILITY OF THE PRODUCT FOR THEIR APPLICATION.
 © 2010 Tyco Electronics Corporation. All rights reserved.

DRAWN G.Rositano 10/30/10
 APPROVED D.Hurrell 11/XX/10
 RPN _____
 CAD FILE: 202D142-XX-35_CD_A
 THIRD ANGLE PROJECTION

CUSTOMER DRAWING
 Raychem Molded Parts
 300 Constitution Drive
 Menlo Park, CA 94025
Tyco Electronics
 TITLE: BOOT, STRAIGHT, with LIP
 SIZE B CODE IDENT. NO. 06090 DWG. NO. 202D142-XX-35
 DO NOT SCALE THIS DRAWING SHEET 1 OF 1